

3.4 Impact on existing private properties

The proposed orientation raises several concerns regarding its impact on neighbouring private residences;

- The levels along the boundary are projected to be raised by approximately 500mm, which could potentially allow for increased visibility into residents' backyards, compromising their privacy.
- Additionally, the spectator seating is proposed to be located within 1 meter of the boundary, impacting the privacy of the private residences
- The sports field is within 5 meters of the boundary, further encroaching on the residential space.
- There is also a risk of light spillage from the upgraded sports field into these private residences, which could disrupt their amenity.



Figure 32: Impact of reference design on privacy of local residents

3.5 Options for field orientation

A rigorous process was undertaken to determine the optimal orientation for the Tamplin Field athletics track, involving the assessment of seven distinct options. These options, including the initial reference design and a southward variation, were evaluated against the five key criteria: the necessity and length of any required culvert, the extent of impact on existing trees, potential effects on neighbouring properties, the achievement of an ideal field of play orientation, and the efficient utilisation of site space.

This detailed assessment aimed to identify the most effective solution for the precinct’s layout. The summary of the assessment of the preferred option (option 2) is shown on the following page. This option forms the basis of the concept design, which is discussed in section 6.

A summary of the assessment is shown in the table on this page.

Criteria					
Option	Culvert required	Tree impact	Impact on neighbours / boundary	Ideal field of play orientation	Efficient use of space
0	107m length	All trees to NW and SW to be removed	Close proximity to neighbours	Outside ideal orientation	Aligns with street orientation & large space for amenities
OB	107m length	All trees on mound can be retained	Close proximity to neighbours	Outside ideal orientation	Aligns with street orientation & large space for amenities
1	70m length	All trees to NW and some to the SE to be removed	Limited impact	Ideal orientation	Large open space for amenities
2	No culvert required	Most trees to NW and SW to be removed	Moderate impact	Within ideal orientation	Large open space for amenities
3	No culvert required	Half of the trees to NW and SW to be removed	Limited impact	Outside ideal orientation	Fragmented left over space
4	85m length	Most trees on mound can be retained	Close proximity to neighbours	Outside ideal orientation	Insufficient space remaining for multi-use
5	100m length	All trees to NW many to SE to be removed	Very close to street & school	Outside ideal orientation	Aligns with street orientation & large space for amenities



Figure 33: Option 0 - Reference design



Figure 34: Option OB - Reference design shifted south



Figure 35: Option 1



Figure 36: Option 2 (preferred)



Figure 37: Option 3



Figure 38: Option 4



Figure 39: Option 5

Preferred option (option 2)

Following the assessment of seven orientation options, Option 2 was identified as the most suitable. This decision was based on key factors including:

- This option includes the realignment of the stormwater channels, which is a cost saving compared to the options with culverts
- This option has a moderate impact on the privacy of neighbouring properties
- This option is within the ideal field of play orientation
- Efficient use of space, with large open space available for the amenities building, multi-use courts and other landscape improvements.

This option is shown in the diagram on this page and is further developed into a concept design, which is discussed in the next sections of this report.



Figure 40: Option 2

4. DESIGN VISION: A PREMIER ATHLETIC AND COMMUNITY PRECINCT

4.1 Vision and Opportunities

The design vision for Tamplin Field is based on the site's context, community engagement, key stakeholders and Council consultation. The vision for Tamplin Fields is to provide:

“A premier athletics facility, a state of the art multi-purpose amenities building, and a community precinct, that caters to a diverse and growing community”, whilst valuing the areas local environment and character”

The upgraded field will become a multi-generational destination that extends beyond its function as a high-quality athletics facility capable of servicing regional events and supporting schools and grassroots athletics development.

Envisioned as an exciting and refreshed piece of public open space, the upgraded park will serve to revitalise the Hobartville area. The renewed Tamplin Field will not be solely defined by its athletics facilities but will also function as an open space hub, incorporating multi-use courts, youth space, plaza area, and an expanded network of accessible pathways. Recognising that the park's periphery is as important as its interior, the design will offer diverse opportunities for the community to explore, picnic, play, exercise, and relax.



Provide a better athletics facility

The existing athletics track at Tamplin Field is only 300 metres in length, falling short of standard competition requirements. Field events are currently dispersed across the site, leading to a fragmented layout that compromises legibility, functionality, and the overall experience for both athletes and spectators. A key objective of the WestInvest grant—secured to fund this upgrade—was the delivery of a new, fit-for-purpose athletics facility. This presents a vital opportunity to consolidate and improve the park's sporting infrastructure, aligning it with contemporary expectations and community aspirations.



Provide a new amenities building

The existing amenities building at Tamplin Field is outdated, does not fully meet the requirements of the users any longer, and is spatially disconnected from the core athletics area.

There is a clear opportunity to deliver a state of the art purpose built facility that is located centrally within the precinct, meets the current and future user needs, is accessible, and supports both sporting excellence and community gathering.

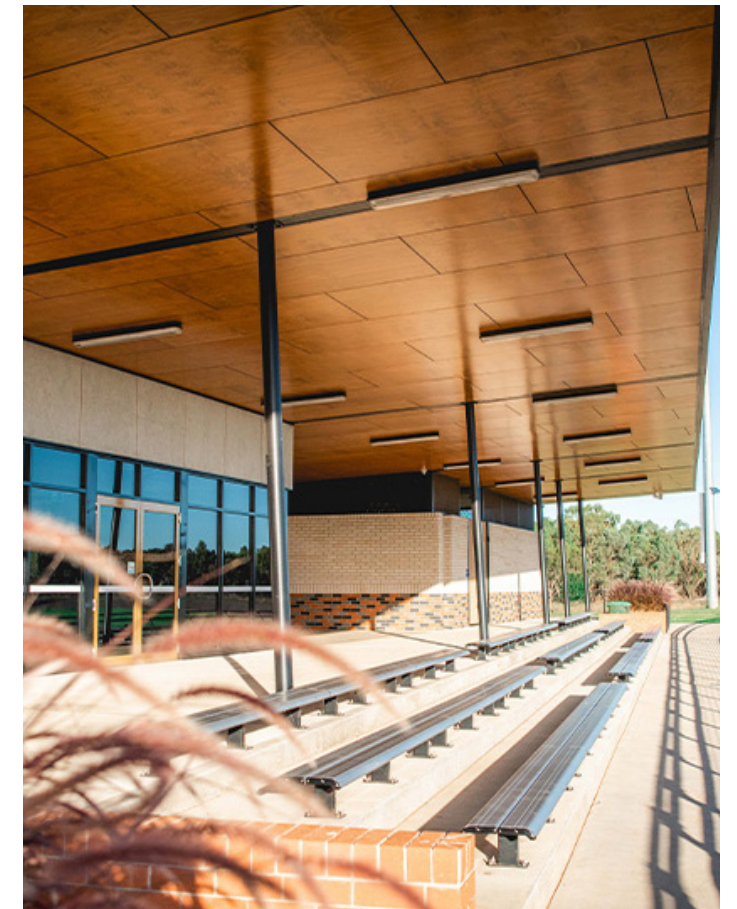

Provide varied seating

The proposed enhancements to Tamplin Field present an exciting opportunity to create a more inviting and engaging environment for spectators. By introducing structured, well-placed formal and informal seating, the space can better celebrate the athletic activities and encourage greater community participation.

Thoughtfully designed seating will not only improve comfort and visibility but also contribute to a lively and inclusive sporting and community atmosphere, transforming Tamplin Field into a true hub of sports and recreation.



Provide a multi-purpose court

The existing court facilities at Tamplin Field are dated and do not offer the flexibility or appeal required by today’s users. There is growing community interest in more diverse and informal recreational opportunities. Re-imagining this part of the park provides an opportunity to introduce a shared space that caters to a wider range of activities and users, strengthening the park’s role as an inclusive and lively destination for all ages.



Provide equitable access & movement

Tamplin Field currently lacks a defined accessible circulation network, with no internal paths connecting key areas of the park. Movement is largely limited to a narrow perimeter footpath located on the road reserve, separated from the park by a low wire fence. This absence of accessible internal routes creates significant barriers for people with limited mobility, prams, or bicycles, and limits the park’s overall functionality. There is a clear opportunity to introduce a cohesive and inclusive path network that improves access, comfort, and wayfinding for all users.



Provide additional parking

Tamplin Field presents a valuable opportunity to enhance visitor experience through improved parking solutions. While on-street parking generally meets day-to-day needs, key events highlight the demand for more structured options. By formalising the existing informal parking areas and introducing accessible spaces, a dedicated drop-off zone, and additional street parking, the precinct can offer safer, more convenient, and inclusive access for all users.



Realigned Stormwater Channels

Along the boundaries of Tamplin Field two stormwater channels are located. These will be required to be realigned to make space for the new sports field. The realignment of the stormwater channels provides an opportunity to incorporate natural elements, sandstone seating walls, and nature play elements into the design, while also ensuring flooding is resolved.

4.2 Site Strategies

The site strategies include key moves that will enable the objectives for the park. These strategies are high-level design principles that inform the design of the Concept Plan for Tamplin Field.

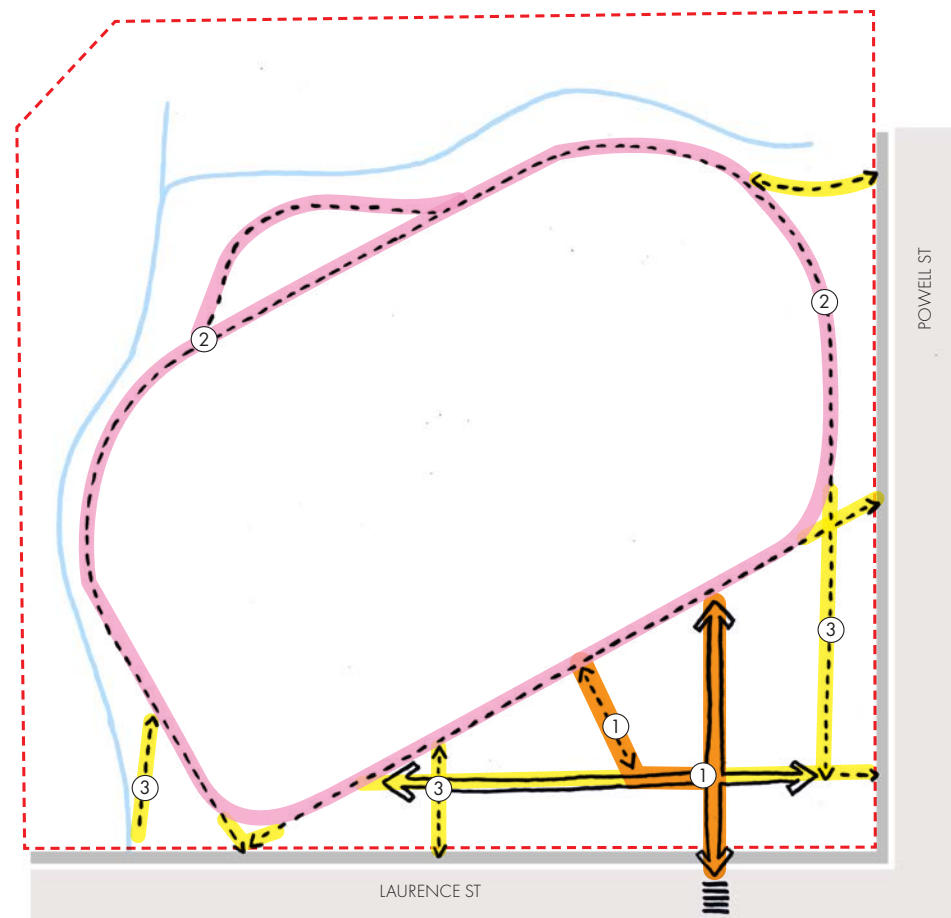

Access and circulation

The circulation strategy for the site establishes a clear hierarchy of access. The primary point of access is from the south-east boundary, connecting directly with the pedestrian crossing on Laurence Street. A second primary access path branches off this main entry, extending north-east through the new amenities building to provide a direct route to the center of the playing field. Secondary paths will then serve to circulate users around the perimeter of the track, offering less direct but still convenient routes.

1. Entry boulevard (civic plaza)
2. The circuit track
3. Passive pedestrian paths/entries

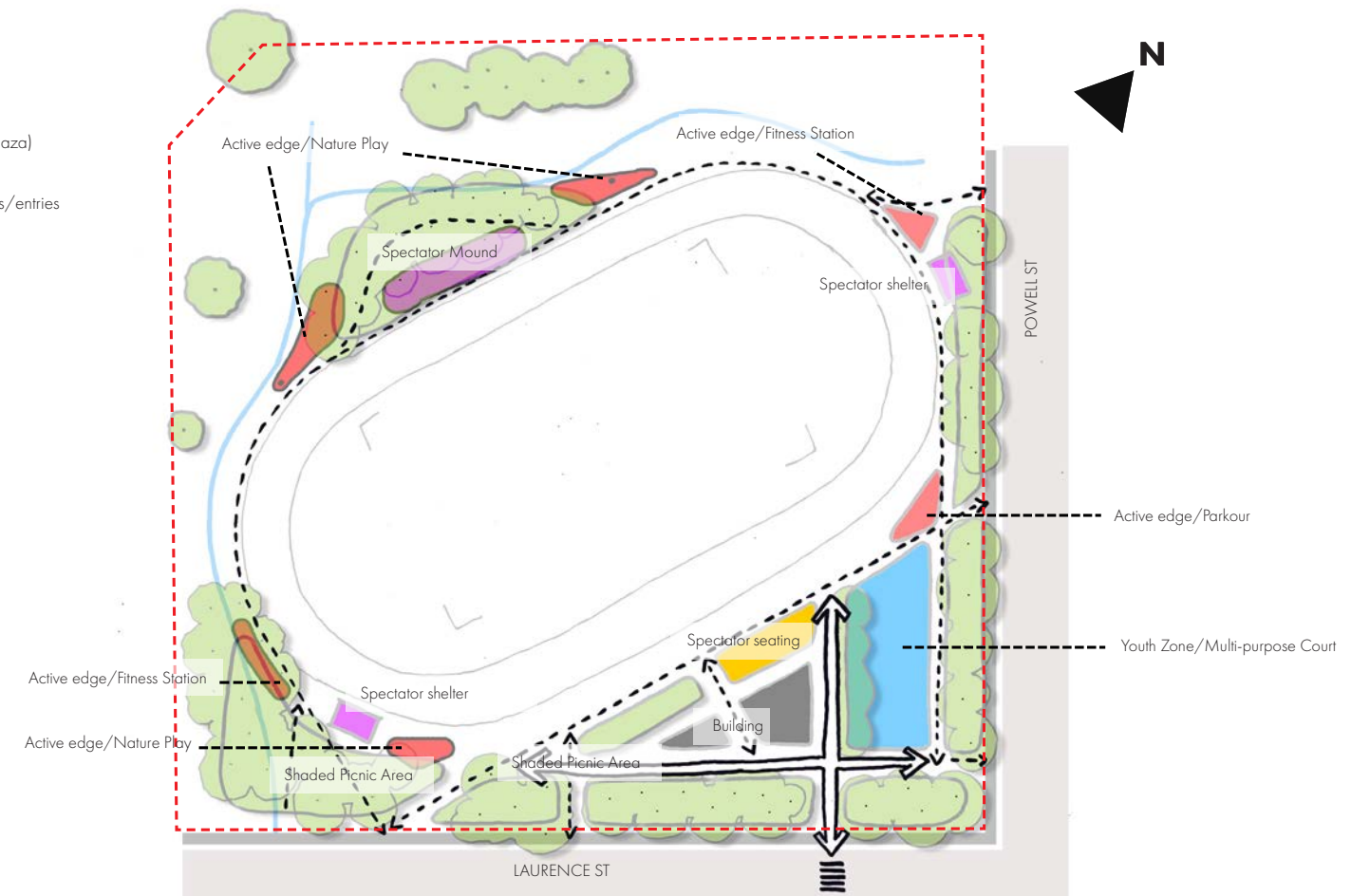

Zones and character areas

The primary access point will be developed into a main boulevard, with the amenities building located to the east, and the youth zone and court to the west. The park's perimeter will incorporate a mix of shaded, informal picnic areas, interspersed with activated edges designed to accommodate various activities. A spectator mound will be included, mirroring the grandstand seating planned in front of the amenities building.

4.3 Materials, planting and colour palette

The design incorporates a carefully curated palette of materials, colours, and finishes that resonate with the character of the site. The proposed materials, planting, and all colours will be further refined and developed during the detailed design stage.

Materials

We propose using a simple and consistent material palette. The materials will need to be robust, cost effective, and suitable for an active athletic and sporting environment, ensuring long-term durability and high utility across the precinct.

Colours

The Tamplin Field colour palette will primarily feature natural, earthy tones, subtly accented with heritage hues. This approach aims to reflect the peri-urban setting, honour local history and the environment, and align with Hawkesbury City Council's vision and regional identity. Furthermore, the palette will draw direct inspiration from the local athletics club logo, ensuring a cohesive visual connection to a key user group and their established identity within the community.

Planting

Hawkesbury City Council priorities native species for landscaping, favouring indigenous plants that are hardy and low-maintenance. Their approach includes retaining existing vegetation and considering climatic influences for optimal placement. For Tamplin Field, this means selecting local native trees, preserving existing healthy trees, and strategically planting for shade and winter sun. Understorey plantings should also use native species to create a layered, low-maintenance landscape, with environmental benefits.

The Tamplin field precinct is home to two vegetation communities; the Cumberland Shale Plains Woodland on the higher ground and the Cumberland Red Gum Riverflat Forest along the channel gullies.

There are several key areas of the park to deploy a refined planting strategy, these include:

- The wide entry boulevard will feature trees selected for their ornamental value, providing visual appeal and defining the entrance.
- Informal picnic areas and the area behind the mound will be planted with shade trees to enhance user comfort and create inviting spaces for recreation.
- The park's perimeter will incorporate a mix of native plantings and shrubs to integrate the park with the surrounding environment, support local biodiversity, and provide habitat.
- The open stormwater channel will be revegetated with riparian species where possible to improve water quality, stabilize the channel banks, and create a valuable ecological corridor.



Sandstone



Concrete



Timber



Steel

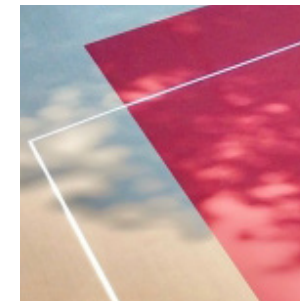

Plexipave acrylic sports surfacing

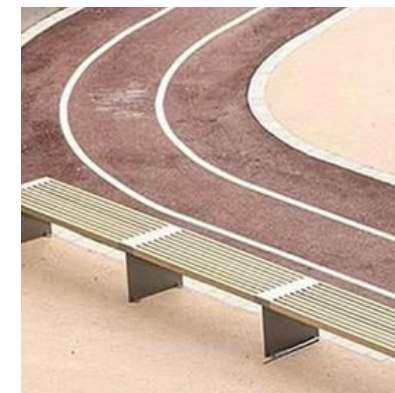
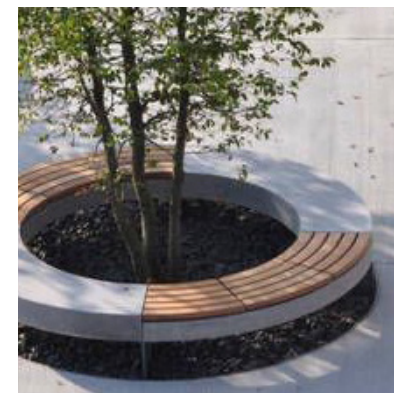

Primary planting: Cumberland Shale Plains Woodland Tree Species (PCTID: 3320)

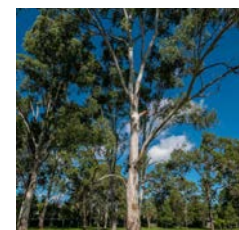

Forest Red Gum
Eucalyptus tereticornis

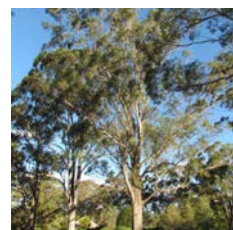

Grey Box *Eucalyptus moluccana*



Narrow-leaved Apple
Angophora bakeri



Parramatta Wattle
Acacia parramattensis

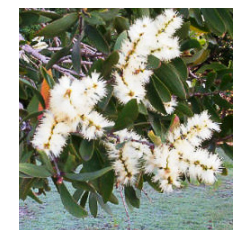

Broad-leaved Paperbark *Melaleuca quinquenervia*



Juniper-leaf Grevillea
Grevillea juniperina



Kangaroo Grass
Themeda triandra



Common Tussock-grass
Poa labillarderei

Stormwater channel planting: Cumberland Red Gum Riverflat Forest (PCT ID: 4025)



Cabbage Gum
Eucalyptus amplifolia



Rough-barked Apple
Angophora floribunda

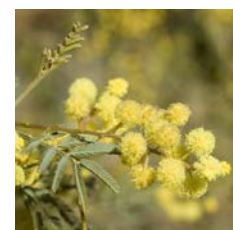

Parramatta Wattle
Acacia parramattensis

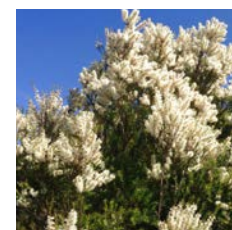

White-feather Honey-myrtle
Melaleuca decora



Tautoon / Tea Tree
Leptospermum polygalifolium



Tall Sedge
Carex appressa

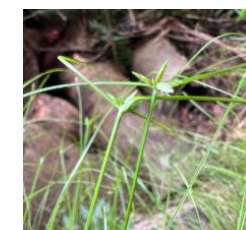

Slender Flat-sedge
Cyperus gracilis



Weeping Grass
Microlaena stipoides

4.3 Community & Stakeholder Consultation

The Tamplin Field redevelopment was shaped by extensive community consultation, forming a key part of the WestInvest Category B funding business case. This engagement, led by Hawkesbury City Council, informed the project Masterplan through strategic documents such as the Community Strategic Plan, Parks and Open Spaces Plan of Management, and Disability Inclusion Action Plan. Across workshops, listening posts, focus groups, and written submissions, the community clearly expressed the need for inclusive, upgraded recreational infrastructure to support a healthier, more connected Hawkesbury.

Following this, further consultation has been undertaken by the design team to ensure the delivery of a high-quality, community-aligned facility. Since January 2025, Civille and G3 Architects have held regular fortnightly meetings with Hawkesbury City Council, including representatives from the Asset Management and Strategic Planning teams, as well as the Council Project Team. These sessions have addressed key elements of the design, such as the orientation of the athletics field, amenities requirements, parking provision, and the aesthetic direction for materials and planting—ensuring alignment with Council’s long-term vision.

Targeted stakeholder engagement has also been conducted with key user groups. In April 2025, the design team met with representatives from the Hawkesbury City Athletics Club (including the President, Vice President and Treasurer) to understand current use patterns, facility gaps, and priorities for athletics participation. That same month, a session with the Hawkesbury Sports Council and a representative from the Hobartville Dog Training program surfaced key concerns around event-day capacity, infrastructure needs, safety, and vandalism.

Together, this feedback has informed a design that reflects community aspirations, responds to current and future demand, and meets the objectives outlined in the WestInvest funding strategy.

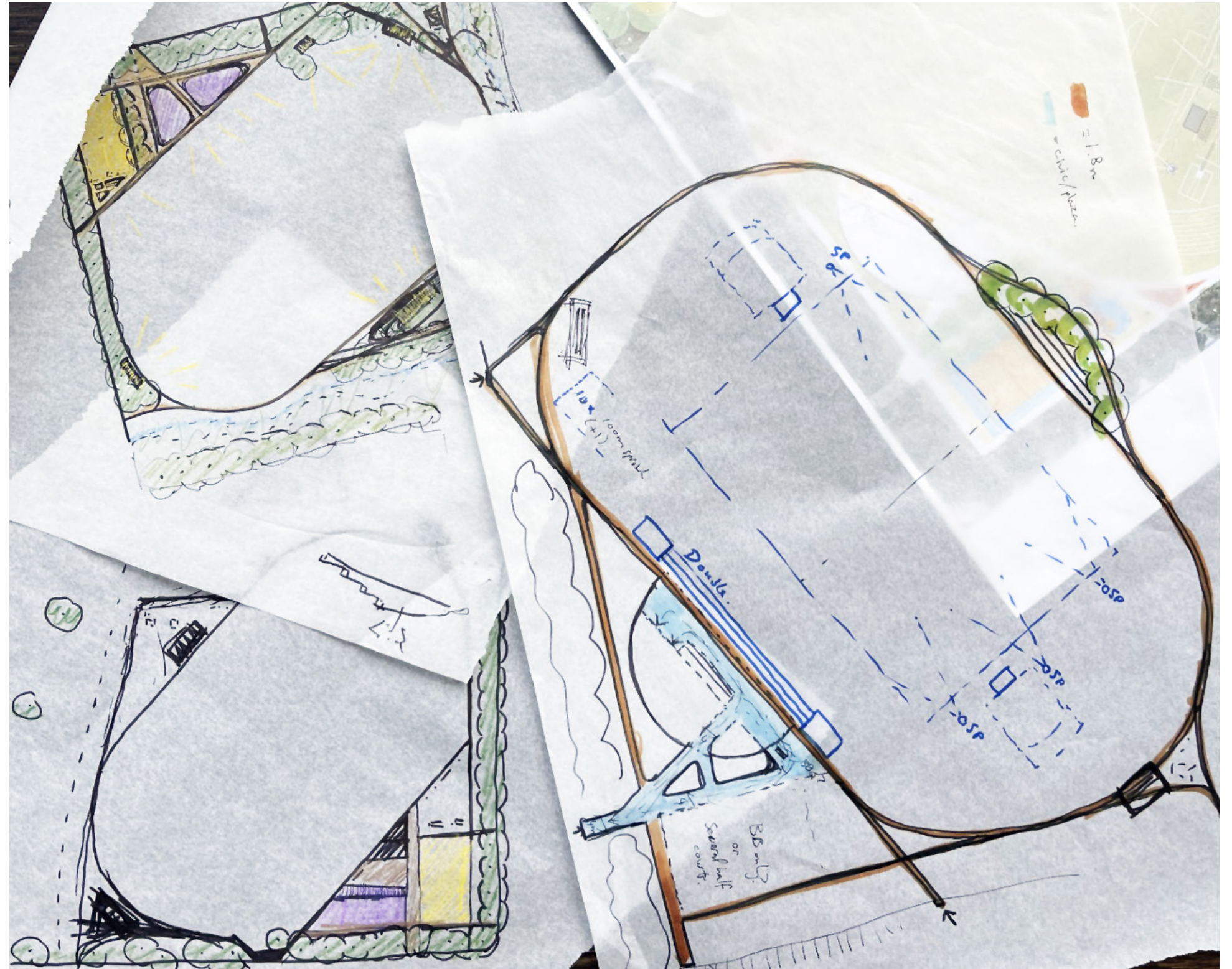

Figure 41: Progression of concept design

CONCEPT DESIGN